

TRIADE PRO MINI



25 mm min.



15 kg per pair for shelf 250 mm deep



SPECIFICATION

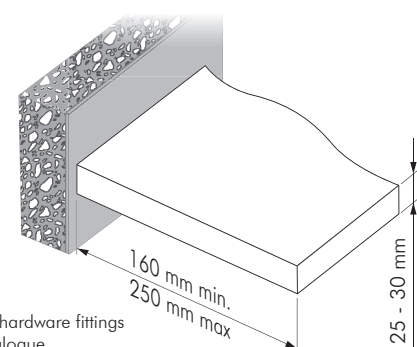
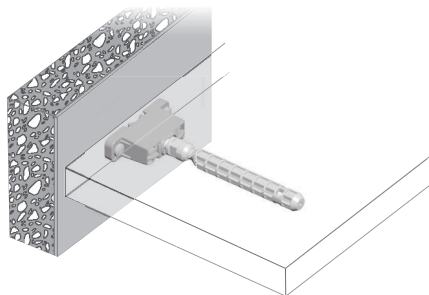
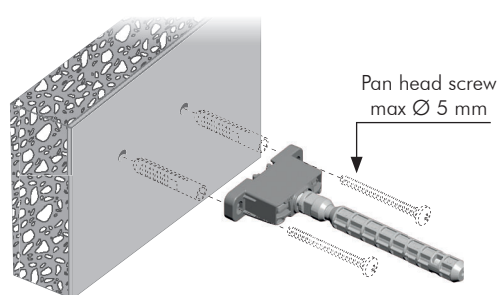

It is the responsibility of the customer: to ensure the wall is of a suitable quality to hold the shelf fixing in place and to use the proper hardware fittings according to the construction of the wall. For more specific information, please refer to the WARNINGS section at the end of the catalogue.

ADJUSTMENT

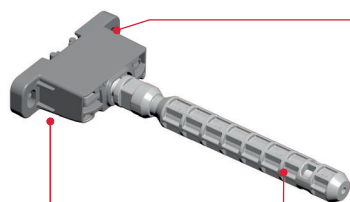
**VERY IMPORTANT**

Screw to lock when adjustments are finished.

BRACKET ALIGNMENT

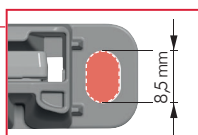

LATERAL ADJUSTMENT

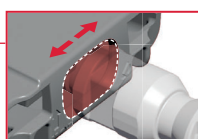

INCLINATION ADJUSTMENT

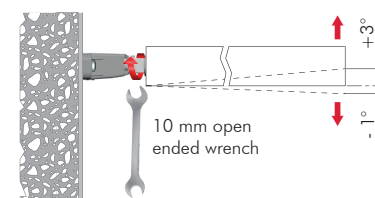
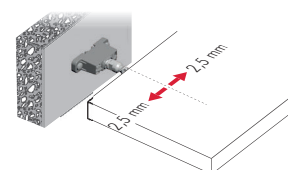
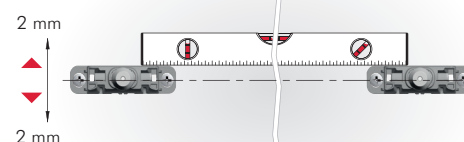
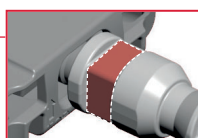

LOADING CAPACITY CHART

(The figures refer to 2 shelf supports)

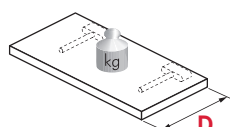
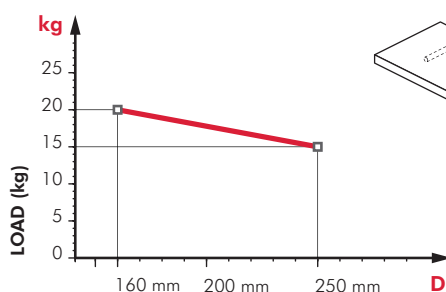

RECOMMENDED NUMBER OF TRIADE PRO MINI PER SHELF

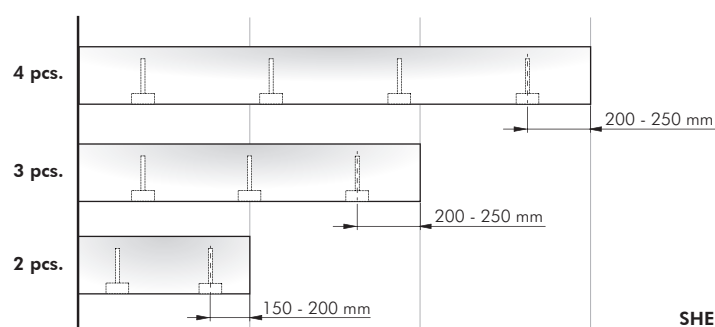

SHELF

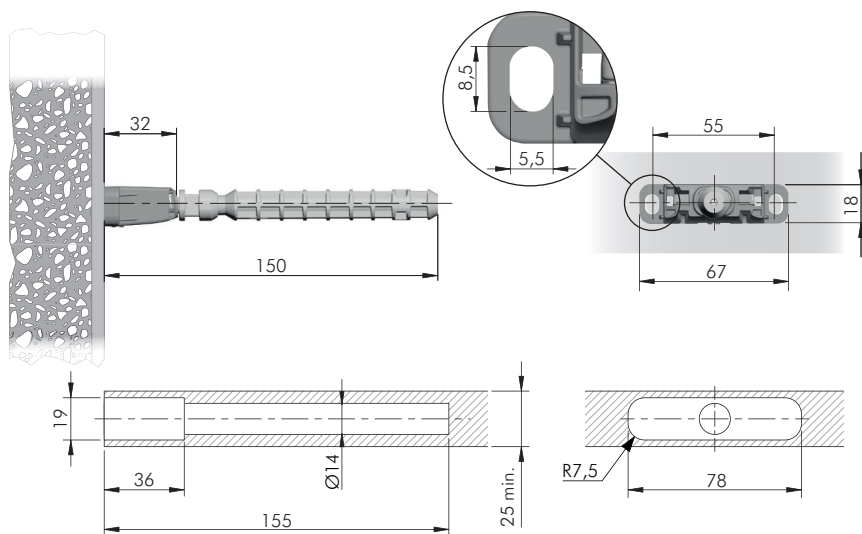

= PZ2 = open ended wrench 10 mm

ZA ST EP

= 50 pcs.



1623001000

OPTIONAL DRILLING FOR SECURITY LOCKING

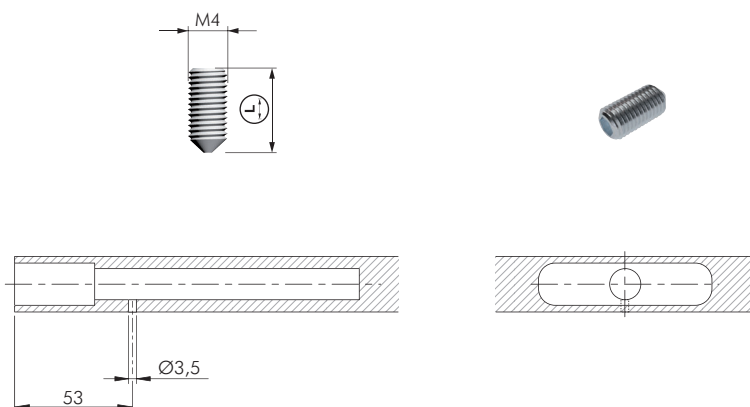

= S2

ST

= on request



21105170ZN



8



25

21105180ZN

10

30

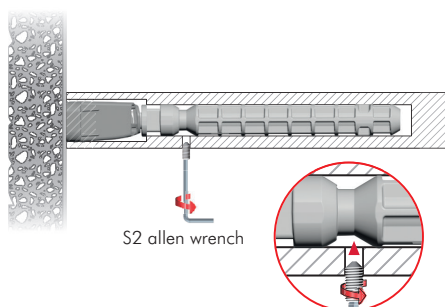

S2 allen wrench

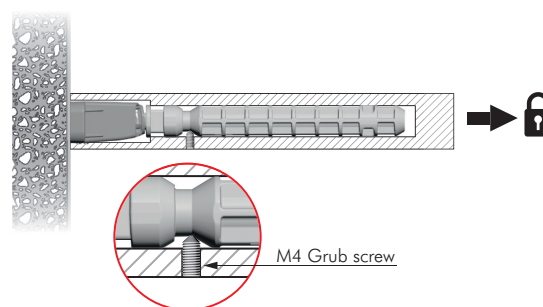

M4 Grub screw